

Metric size	M5 x 2.24 mm
US size (converted)	#11-11
	Tolerances [inch]
Length	+/- 0.031
Head diameter	+0 / -0.022
Head height	+/- 0.005
Thread diameter	+0.007 / -0

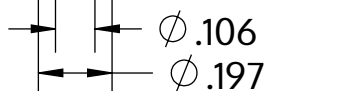

Descriere	STP38A 5.0x50.0 - T20
Material	oțel, călit
Exterior	zincat 5-7 μm , recopt, pasivat transparent/albastru
Greutate	4.684 kg / 1000 unități



SCREWERK

STP38A0500500S

_Zoll Zeichnung Größe A

Scalarea None:1

2024-04