

|                     |                   |
|---------------------|-------------------|
| Metric size         | M5 x 2.24 mm      |
| US size (converted) | #11-11            |
|                     | Tolerances [inch] |
| Length              | +/- 0.031         |
| Head diameter       | +0 / -0.022       |
| Head height         | +/- 0.005         |
| Thread diameter     | +0.007 / -0       |

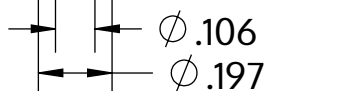

|              |                                |
|--------------|--------------------------------|
| Opis         | STP38A 5.0x50.0 - T20          |
| Materiał     | Stal szlachetna A2             |
| Powierzchnia | Prosta, bejcowana i pasywowana |
| Waga         | 4.684 kg / 1000 sztuk          |



**SCREWERK**

**STP38A0500500E**

\_Zoll Zeichnung Größe A

Skala None:1

2024-04