

Metric size	M5 x 1.8 mm
US size (converted)	#11-14
	Tolerances [inch]
Length	+/- 0.031
Head diameter	+0 / -0.027
Head height	+/- 0.005
Thread diameter	+0.005 / -0

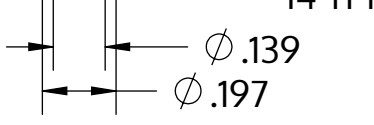

Description	STP38 5.0x50.0 - T25
Material	stainless-steel A2
Surface	bright, pickled and passivated
Weight	6.120 kg / 1000 pieces



**STP380500500E**

Inch Drawing Size A	Scale None:1	2024-04
---------------------	--------------	---------