

Metric size	M5 x 2.24 mm
US size (converted)	#11-11
	Tolerances [inch]
Length	+/- 0.031
Head diameter	+0 / -0.014
Head height	
Thread diameter	+0.007 / -0

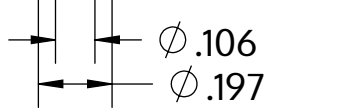

Description	STP33A 5.0x50.0 - H2
Material	steel, hardened
Surface	zinc-plated 5-7 μ m, baked, blue / transparent passivated
Weight	4.226 kg / 1000 pieces



SCREWERK

STP33A0500500S

Inch Drawing Size A

Scale None:1

2024-04