

Metric size	M5 x 2.24 mm
US size (converted)	#11-11
	Tolerances [inch]
Length	+/- 0.031
Head diameter	+0 / -0.022
Head height	+/- 0.005
Thread diameter	+0.007 / -0

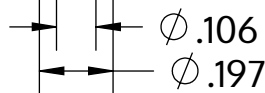

Beschrijving	STP31A 5.0x50.0 - H2
Materiaal	roestvrij staal A2
Oppervlak	blank, geetst en gepassiveerd
Gewicht	4.707 kg / 1000 stuk



**SCREWWERK**

**STP31A0500500E**

\_Zoll Zeichnung Größe A

Schaal 2:1

2024-05