

Metric size	M5 x 2.24 mm
US size (converted)	#11-11
	Tolerances [inch]
Length	+/- 0.031
Head diameter	+0 / -0.022
Head height	+/- 0.005
Thread diameter	+0.007 / -0

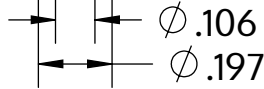

Descripción	STP21A 5.0x50.0 - Z2
Material	Acero Inoxidable A2
Superficie	Laminado brillante, barnizado y pasivado
Peso	4.766 kg / 1000 Piezas



SCREWERK

STP21A0500500E

_Zoll Zeichnung Größe A

Escalada None:1

2024-04