

**Technische gegevens**  
**STM390600160B**

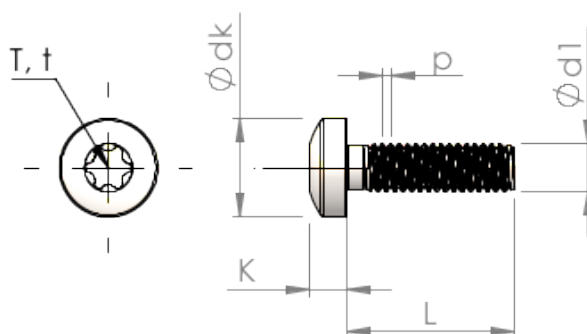

|                       |           |   |
|-----------------------|-----------|---|
| Produktnummer         |           | STM390600160B                                 |
| Norm                  |           | ISO 14583                                     |
| Materiaal             |           | veredeld staal                                |
| Oppervlak             |           | ZnNi zwart-gepassiveerd, getempert, verzegeld |
| Schroefdraad buiten-Ø | <b>d1</b> | 6.00 mm                                       |
| Spoed                 | <b>p</b>  | 1.00 mm                                       |
| Lengte                | <b>L</b>  | 16.00 ±0.55 mm                                |
| Kop-Ø                 | <b>D</b>  | 12.00 <sub>-0.43</sub> mm                     |
| Kop hoogte            | <b>K</b>  | 4.600 <sub>-0.300</sub> mm                    |
| TX                    |           | T30   |
| Indringdiepte         | <b>t</b>  | 2.02 - 2.42 mm                                |
| Gewicht               |           | 5.469 kg / 1000 stuk                          |
| Douane tarief nummer  |           | 73 181 595                                    |